



Counterbores

For Ejector Pins

DMS "Ejector Pin" Counterbores are made from the finest quality High Speed Steel available. They are ground from solid pre-hardened steel to exact tolerances and specifications. The three flute design gives rigid performance and maximum chip clearance. A built-in chamfer allows clearance for the radius under the ejector pin head and provides proper seating of the pin.

COUNTERBORE SET

Counterbores are available in a set of 7 of the most popular sizes ($\frac{1}{8}$, $\frac{3}{32}$, $\frac{1}{4}$, $\frac{5}{16}$, $\frac{3}{8}$, $\frac{1}{2}$) at additional savings. Supplied with wooden block.

CATALOG NUMBER
CB-SET

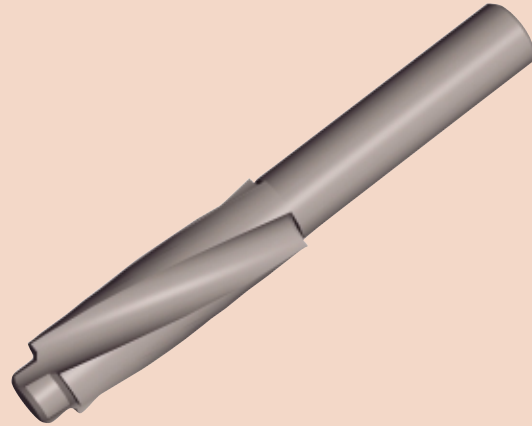

Catalog Number	Ej. Pin Diameter	C'Bore Body Dia.	Pilot Length	Shank Diameter	Overall Length
CB-12	1/8	17/64	3/16	1/4	2-5/8
CB-14	9/64	17/64	3/16	1/4	2-5/8
CB-15	5/32	19/64	3/16	1/4	2-3/4
CB-17	11/64	23/64	3/16	1/4	3-1/16
CB-18	3/16	25/64	3/16	3/8	3-1/4
CB-20	13/64	25/64	3/16	3/8	3-1/4
CB-21	7/32	27/64	1/4	3/8	3-3/8
CB-23	15/64	27/64	1/4	3/8	3-3/8
CB-25	1/4	29/64	1/4	7/16	3-9/16
CB-26	17/64	29/64	1/4	7/16	3-9/16
CB-28	9/32	29/64	1/4	7/16	3-9/16
CB-29	19/64	33/64	5/16	1/2	3-7/8
CB-31	5/16	33/64	5/16	1/2	3-7/8
CB-32	21/64	37/64	5/16	1/2	4-1/8
CB-34	11/32	37/64	5/16	1/2	4-1/8
CB-35	23/64	41/64	5/16	5/8	4-1/2
CB-37	3/8	41/64	5/16	5/8	4-1/2
CB-40	13/32	45/64	5/16	5/8	4-3/4
CB-43	7/16	45/64	5/16	5/8	4-3/4
CB-46	15/32	49/64	5/16	5/8	5-1/8
CB-50	1/2	49/64	5/16	5/8	5-1/8
CB-56	9/16	53/64	5/16	5/8	5-3/8
CB-62	5/8	57/64	5/16	5/8	5-5/8
CB-68	11/16	61/64	5/16	5/8	5-7/8
CB-75	3/4	1-1/64	5/16	5/8	6-1/4
CB-87	7/8	1-9/64	5/16	3/4	6-1/4
CB-90	1	1-17/64	5/16	3/4	6-1/4



Sizes marked in blue print are due to be discontinued. Call for availability.